



Single channel centrifugal drainage pumps. Specifically designed for heavy duty applications they guarantee high capacity at medium head; ideal for civil and industrial applications. Available in mobile or permanent version with coupling feet.

Construction features

Pump body	cast iron
 Impeller	cast iron
Mechanical seal	double seal with oil barrier: silicon carbide on pump side, ceramic-graphite on motor side
Motor shaft	stainless steel AISI 304
Free passage	Ø max 50 mm
Max submergence	20 m
Liquid temperature	0 - 40 °C
Cable	H07 RN8F, 10 m
Bolts	A2 stainless steel
Foot support	galvanized iron
Gaskets	NBR rubber

Motor

	3- 220V - 60Hz
	3- 380V - 60Hz
	3- 220/380V - 60Hz
2 Poles induction motor	1- 220V - 60Hz required run capacitor (35µF for 1,5HP model, 50µF for 2HP model)
Insulation class	F
Protection degree	IPX8

TYPE	LOTS			
	TRUCK		CONTAINER	
	PALLET (cm)	N° pumps	PALLET (cm)	N° pumps
DM 160-310	85×110×145	18	85×110×190	27
DMT 410-560	85×110×170	12	85×110×170	12

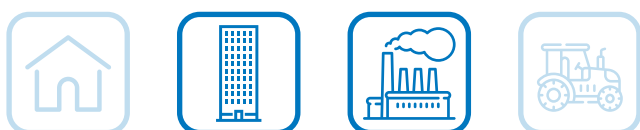

DM

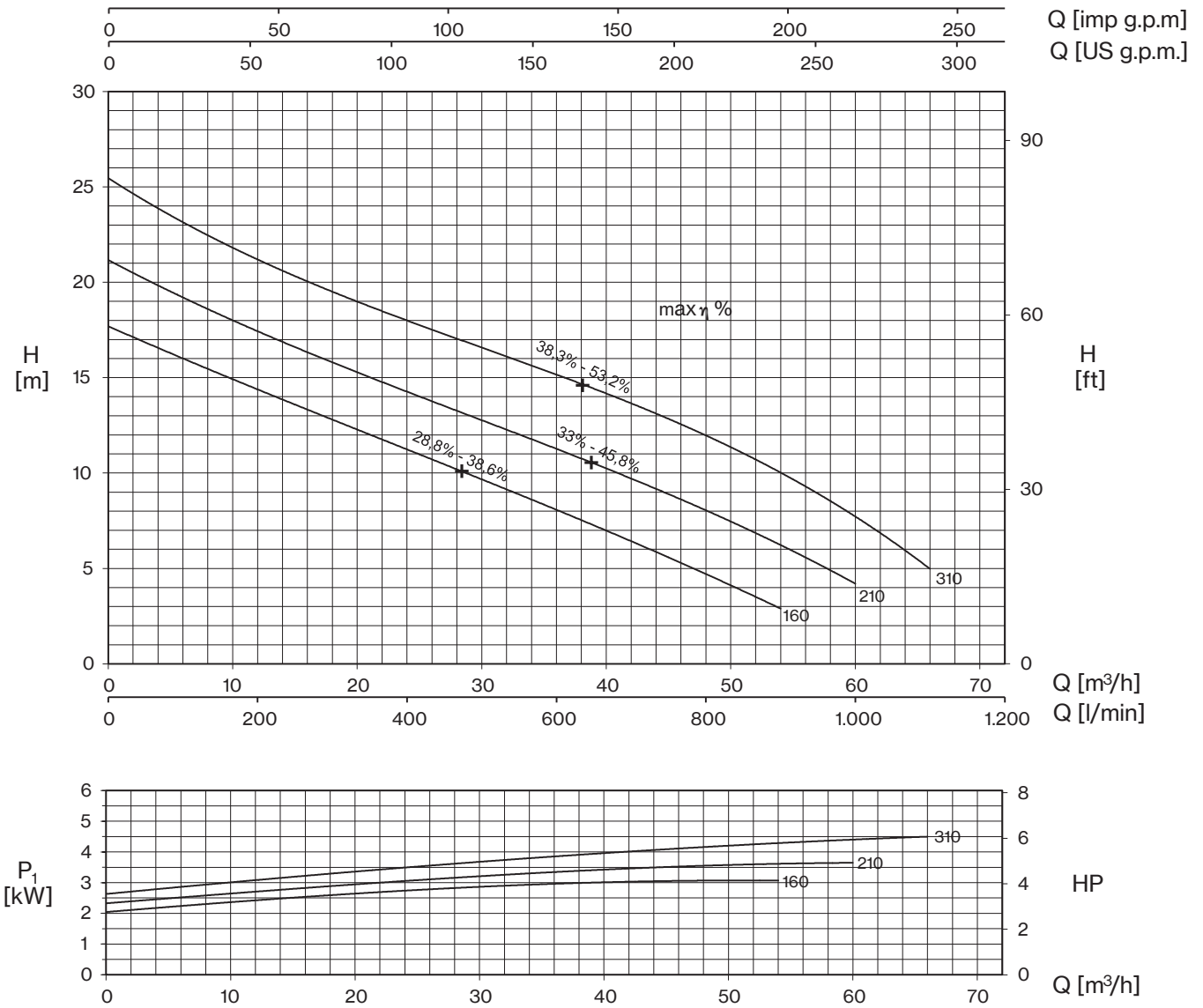

TYPE		AMPERE			
1~	3~	220 V 60 Hz	3x220 V 60 Hz	3x380 V 60 Hz (*)	220/380 V 60 Hz λ / Δ
DM 160	DMT 160	15,8	9,5	5,5	-
DM 210	DMT 210	18,5	11,2	6,5	-
-	DMT 310	-	14	8,1	-

+ max η %

max hydraulic efficiency and respective total efficiency

(*) no standard execution

TYPE		P2		P1 (kW)		Q (m³/h - l/min)											
1~	3~	HP	kW	1~	3~	0	6	12	18	24	30	36	42	48	54	60	66
						0	100	200	300	400	500	600	700	800	900	1000	1100
						H (m)											
DM 160	DMT 160	1,5	1,1	3,3	3,1	17,7	16	14,4	12,8	11,2	9,7	8,1	6,4	4,7	2,9		
DM 210	DMT 210	2	1,5	3,9	3,6	21,2	19,1	17,5	15,9	14,2	12,7	11,3	9,7	8,1	6,2	4,2	
-	DMT 310	3	2,2	-	4,6	25,3	23,2	21,4	19,7	18,0	16,4	14,9	13,5	12	10,2	8,2	4,6



DM

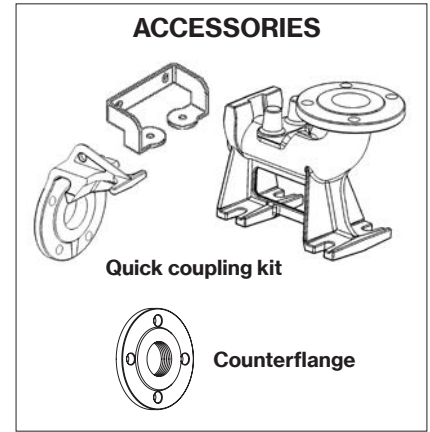
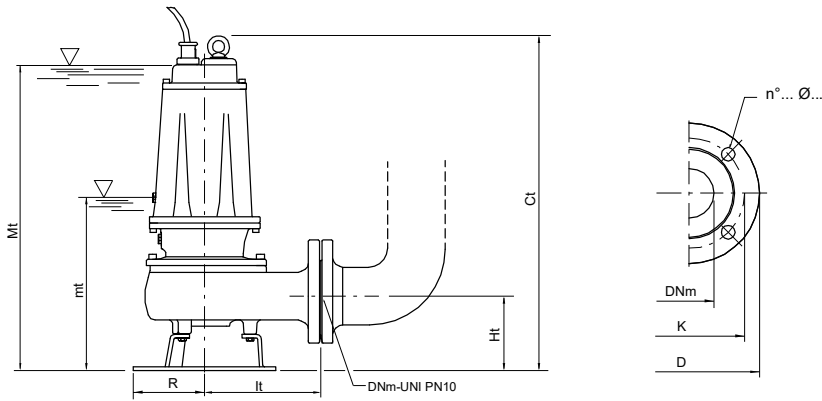

mt: minimum working level
Mt: minimum submersion level for continuous duty

TYPE	DIMENSIONS (mm)							Kg
	Ct	Ht	R	It	mt	Mt	DNM	
DMT 160	551	123	117	191	243	513	65	40
DM 160-DMT 210	551	123	117	191	243	513	65	41,5
DM 210-DMT 310	551	123	117	191	243	513	65	42
DMT 410	645	148	160	210	285	600	80	68,5
DMT 560	645	148	160	210	285	600	80	71

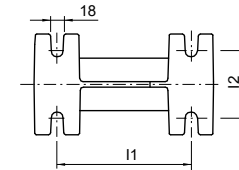
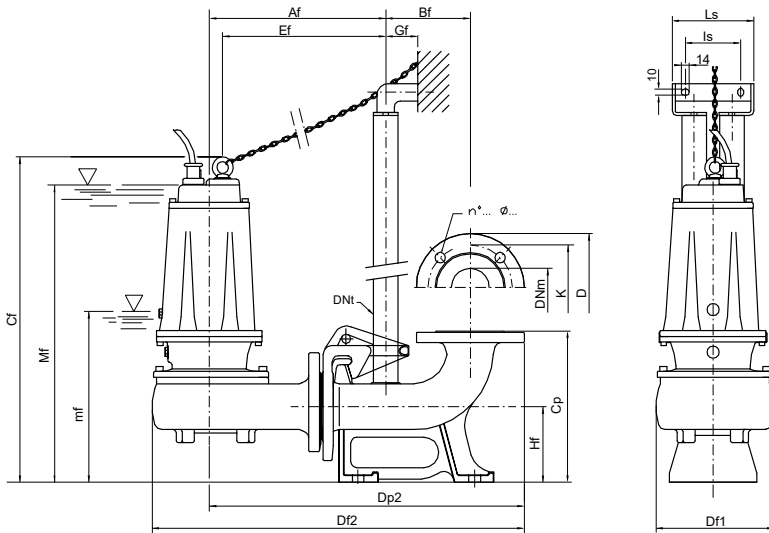

mf: minimum working level
Mf: minimum submersion level for continuous duty

TYPE	DIMENSIONS (mm)																	
	Af	Bf	Cf	Cp	Df1	Df2	Dp2	DNt	Ef	Gf	Hf	I1	I2	Is	Ls	mf	Mf	DNM
DMT 160/P	303	145	560	260	200	639	542	1" 1/4	280	55	130	200	100	95	140	251	521	65
DM 160 / DMT 210/P	303	145	560	260	200	639	542	1" 1/4	280	55	130	200	100	95	140	251	521	65
DM 210 / DMT 310/P	303	145	560	260	200	639	542	1" 1/4	280	55	130	200	100	95	140	251	521	65
DMT 410/P	350	165	690	340	220	722	615	2"	319	85	190	250	140	130	180	327	642	80
DMT 560/P	350	165	690	340	220	722	615	2"	319	85	190	250	140	130	180	327	642	80

Flange UNI PN 10 (mm)			
DNM	K	D	n°... Ø...
65	145	185	4... 18...
80	160	200	8... 18...

